



# HERE Maps & Location Services WebApp Backend Template

## Deployment Guide

Version 8.0.0.0



# Important Information

## Notices

---

Topics:

- [Legal Notices](#)
- [Document Information](#)



## Legal Notices

---

© 2018 HERE Global B.V. and its Affiliate(s). All rights reserved.

This material, including documentation and any related computer programs, is protected by copyright controlled by HERE. All rights are reserved. Copying, including reproducing, storing, adapting or translating, any or all of this material requires the prior written consent of HERE. This material also contains confidential information, which may not be disclosed to others without the prior written consent of HERE.

### Trademark Acknowledgements

HERE is trademark or registered trademark of HERE Global B.V. Other product and company names mentioned herein may be trademarks or trade names of their respective owners.

### Disclaimer

This content is provided "as-is" and without warranties of any kind, either express or implied, including, but not limited to, the implied warranties of merchantability, fitness for a particular purpose, satisfactory quality and non-infringement. HERE does not warrant that the content is error free and HERE does not warrant or make any representations regarding the quality, correctness, accuracy, or reliability of the content. You should therefore verify any information contained in the content before acting on it.

To the furthest extent permitted by law, under no circumstances, including without limitation the negligence of HERE, shall HERE be liable for any damages, including, without limitation, direct, special, indirect, punitive, consequential, exemplary and/ or incidental damages that result from the use or application of this content, even if HERE or an authorized representative has been advised of the possibility of such damages.

## Document Information

---

### Product

Name: HERE Location Services WebApp Backend Template Deployment Guide

Version: Version 8.0.0.0

### Document

Name: HERE Location Services WebApp Backend Template Deployment Guide

Status: FINAL

Date: 2019-Apr-09, 12:00 (GMT)

---



# Contents

---

Notices .....	2
Legal Notices .....	3
Document Information.....	4
Contents .....	5
Overview.....	6
Introduction.....	7
Solution Template Overview .....	7
Deployment Guide .....	9
Acquiring HERE API Key.....	10
Deploying Solution Template on Azure Portal.....	10



# Chapter 1

## Overview

---

### Topics:

- [Introduction](#)
- [Solution Template Overview](#)

This document introduces the deployment steps for HERE Maps & Location Services WebApp Backend Template on Azure Marketplace. The HERE Location Services WebApp Backend Template is a Solution Template on Azure Marketplace which deploys the HERE Maps & Location Services WebApp Backend into your resources along with a ServiceBus and CosmosDB.

## Introduction

---

HERE Maps and Location Services WebApp Backend bring enterprise-grade, SLA backed location services to Azure applications. HERE Maps and location services solve a range of problems from map visualization, navigation and routing, geocoding, time zone look ups to geofencing, custom locations and routing, route matching GPS traces, geospatial, sequencing multiple waypoints, truck routing, positioning, etc.

## Solution Template Overview

---

HERE Maps & Location Services WebApp Backend Template deploys HERE's enterprise class SLA backed Maps & Location Services, a ServiceBus and a CosmosDB for all your Azure Applications.

These services address a range of use cases like Fleet Utilization, Supply Chain Optimization, Urban Movement, etc., and open up new location intelligence opportunities in diverse industries like Automotive, Insurance, Internet and Media, Mobile Payments, Public Sector and Infrastructure, Telecom and Utilities, and Transportation and Logistics.

The function app in this ARM Template consists of the following HERE Location Service APIs:

### Geocoding and Search

- Geocoder: Forward and Reverse
- Batch Geocoder
- Geocoder Autocomplete
- Places

### Maps

- Map Image
- Map Tile

### Navigation and Routing

- Routing - Mode (car, truck, public transit, bicycle) and algorithm (matrix, isoline routing)



### Fleet Telematics

- Considering toll costs along a route
- Working with geofences
- Working with custom locations
- Building custom routes
- Integrating advanced HERE data sets
- Route matching GPS traces
- Calculating an optimal sequence of waypoints

### More APIs

- Positioning - Provides positioning estimates based on global Wi-Fi and Cell coverage, which includes the latitude and longitude of the position with accuracy.





## Chapter 2

### Deployment Guide

---

#### Topics:

- [Acquiring HERE API Key](#)
- [Deploying Solution Template on Azure Portal](#)

## Acquiring HERE API Key

All users of HERE APIs must obtain authentication and authorization credentials and provide them as values for the parameter HERE API Key in the HERE Credentials section in Azure's template deployment page.

To obtain the credentials for the deployment of HERE Maps & Location Services WebApp Backend, please visit <https://developer.here.com> to register for FREE with HERE.

## Deploying Solution Template on Azure Portal

The below steps help you deploy HERE Maps & Locations Services WebApp Backend Template in your Azure resource group.

**Step 1:** Click on “Get it Now” button to start the deployment process.

Figure 1: HERE Maps & Location Services for WebApp Backends in Azure Marketplace

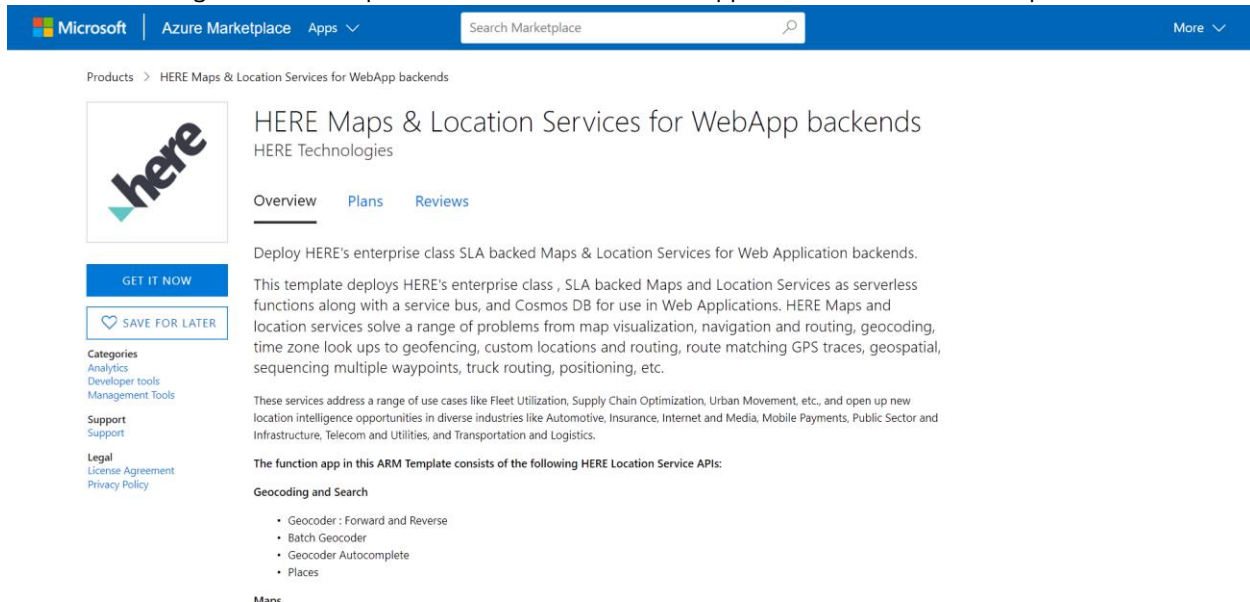

# HERE Maps & Location Services WebApp Backend Deployment Guide

► Deployment Guide



Step 2: Read through the Microsoft agreement and click on “Continue” when you are ready.

Figure 2: HERE Maps & Location Services WebApp Backend Pricing Page

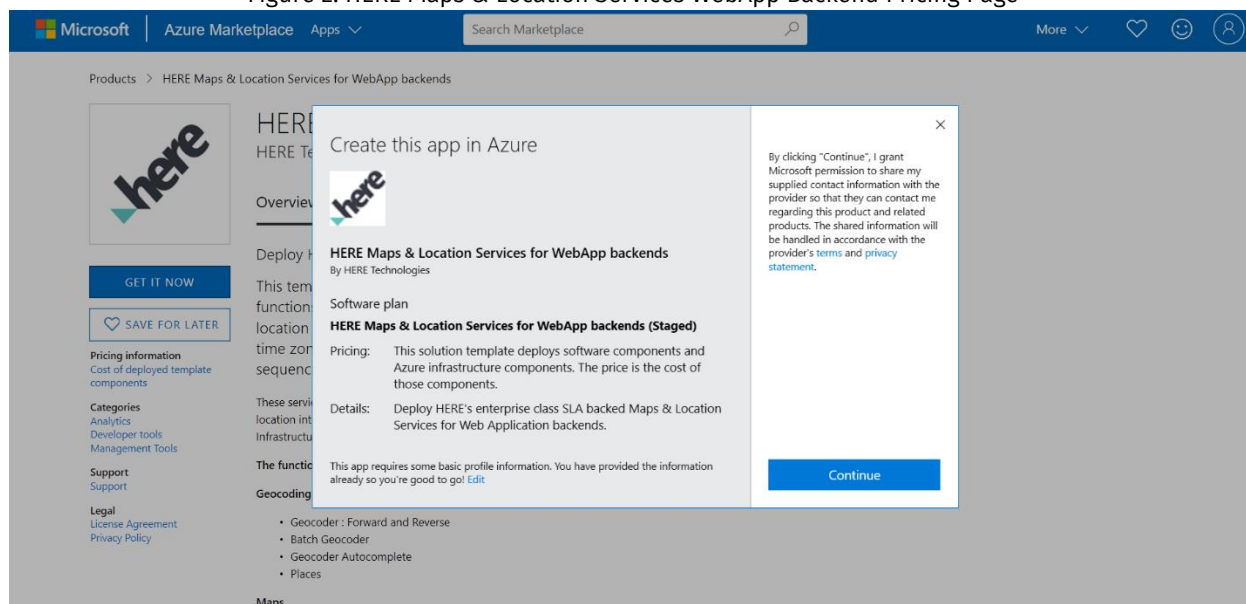

Step 3: You will be re-directed to template deployment home screen. Click on “Create” button to continue.

Figure 3: HERE Maps & Locations Services WebApp Backend Azure Portal Page

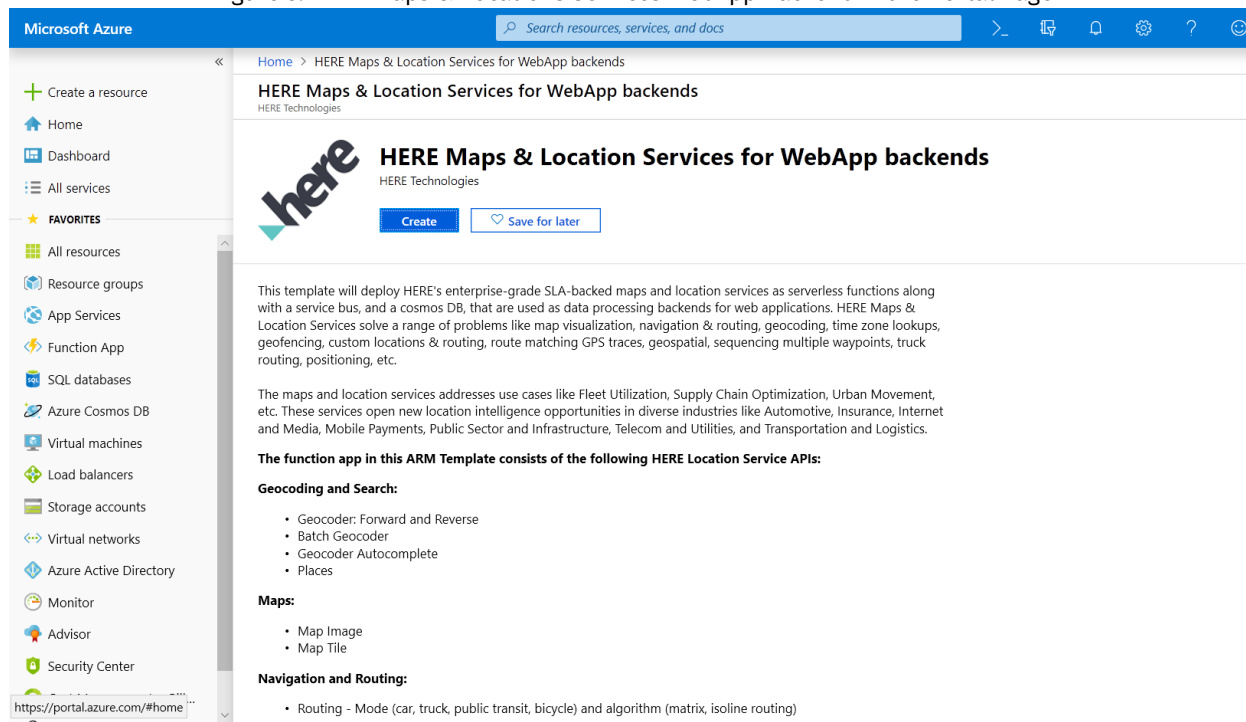

**Step 4:** You will now be prompted to provide details specific to deployment. In the “Basics” use any existing resource group you might have or click on “create new” button to create a new resource group. Select your Subscription details and location and click “OK” to continue.

Figure 4: Template Deployment Page - Basic Section

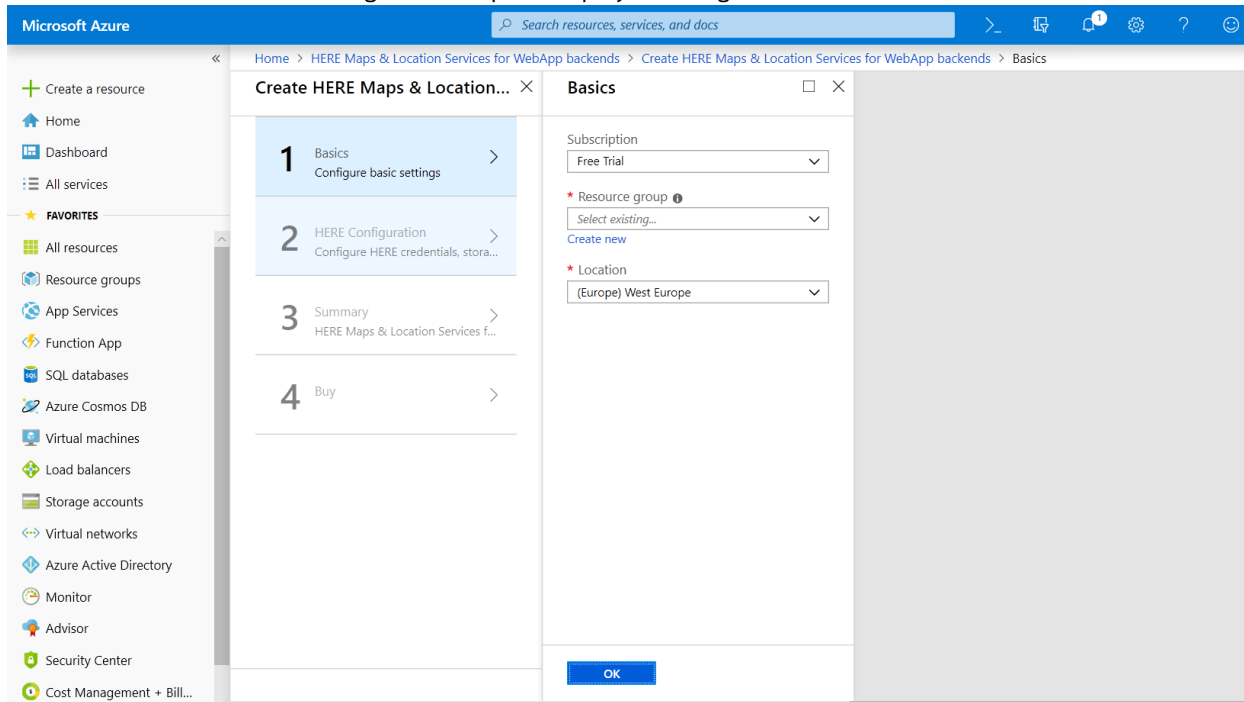
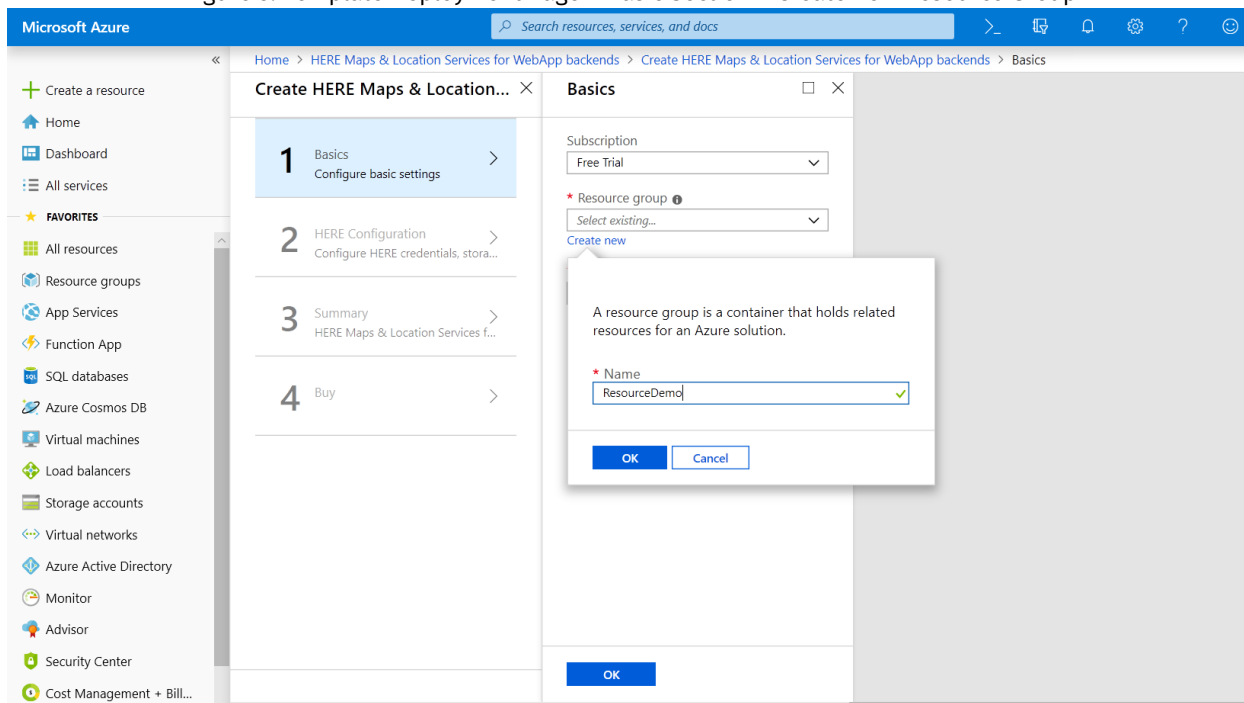
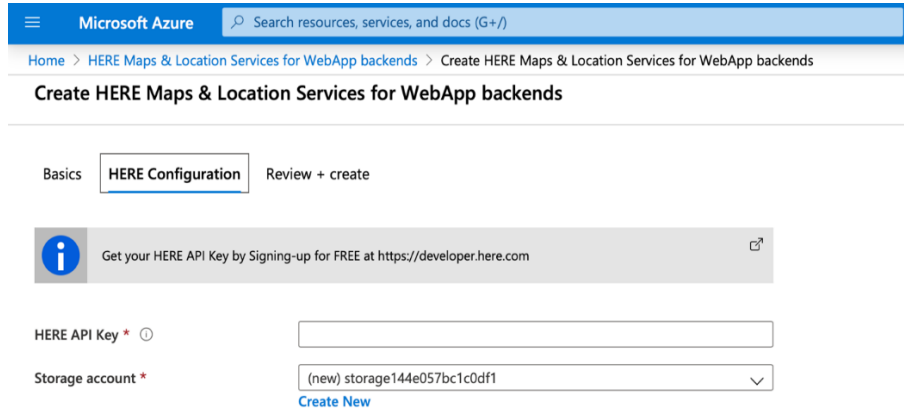

Figure 5: Template Deployment Page – Basic Section – Create new Resource Group



**Step 5:** You now need to provide HERE credentials (HERE API Key) which are pre-requisite to access HERE resources. If you already have HERE credentials available with you, provide the same and click “OK”. If you don’t have HERE credentials, please visit <https://developer.here.com> to register for FREE with HERE. You also need to select a Storage option, you can either select any existing Storage or continue with a newly created one.

Figure 6: Template Deployment Page – HERE Credentials Section



Microsoft Azure Search resources, services, and docs (G+)

Home > HERE Maps & Location Services for WebApp backends > Create HERE Maps & Location Services for WebApp backends

### Create HERE Maps & Location Services for WebApp backends

Basics **HERE Configuration** Review + create

**i** Get your HERE API Key by Signing-up for FREE at <https://developer.here.com>

HERE API Key \* ⓘ

Storage account \* (new) storage144e057bc1c0df1 ▼  
[Create New](#)

Figure 7: Template Deployment Page – Storage Selection

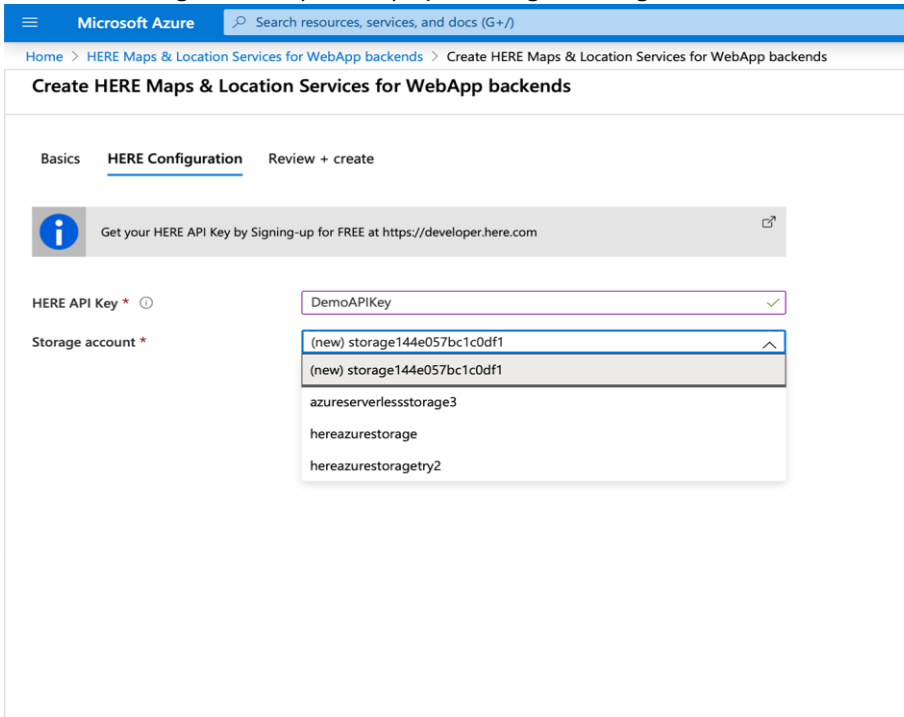

Microsoft Azure Search resources, services, and docs (G+)

Home > HERE Maps & Location Services for WebApp backends > Create HERE Maps & Location Services for WebApp backends

### Create HERE Maps & Location Services for WebApp backends

Basics **HERE Configuration** Review + create

**i** Get your HERE API Key by Signing-up for FREE at <https://developer.here.com>

HERE API Key \* ⓘ  ✓

Storage account \* (new) storage144e057bc1c0df1 ^  
 (new) storage144e057bc1c0df1  
 azureserverlessstorage3  
 hereazurestorage  
 hereazurestorage2

**Step 6:** You will see the summary of details, which were provided during the previous steps. Review the values and click “OK” once you are satisfied with all values.

Figure8: Template Deployment Page – Summary Section

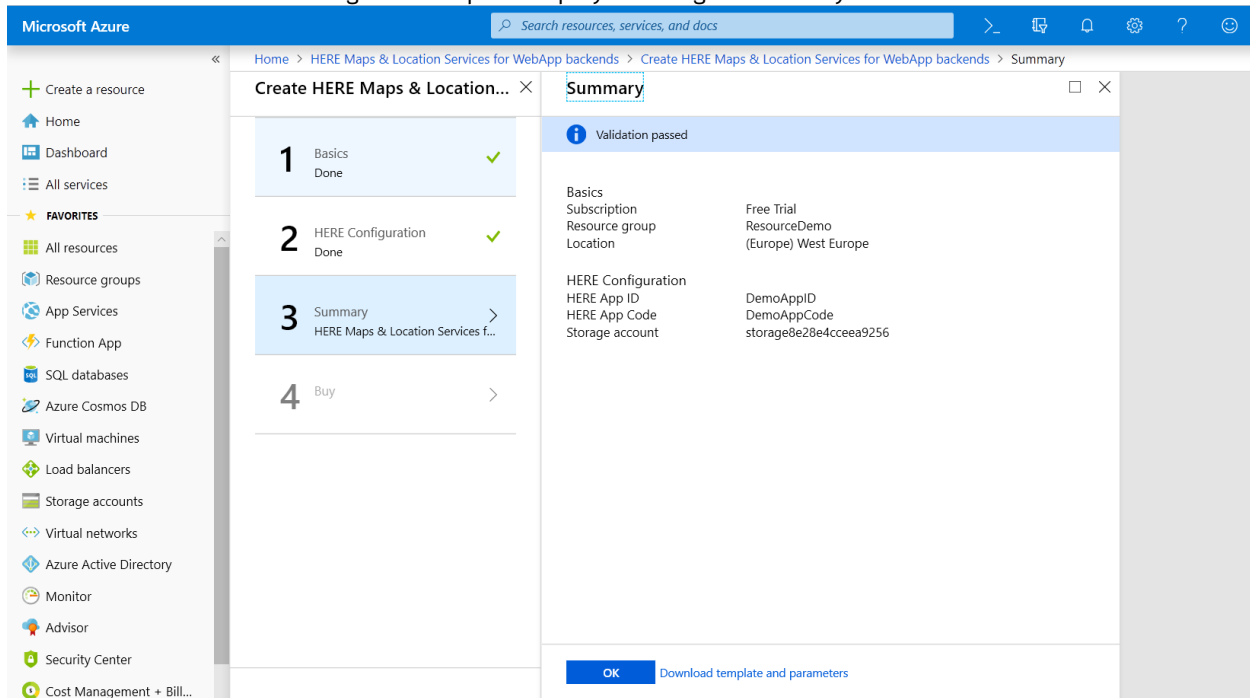

**Step 7:** Review the master agreement and click the check box at the bottom of agreement. You are now ready for template deployment. Click on “Create” to start template deployment.

Figure 9: Template Deployment Page – Create/Buy Section

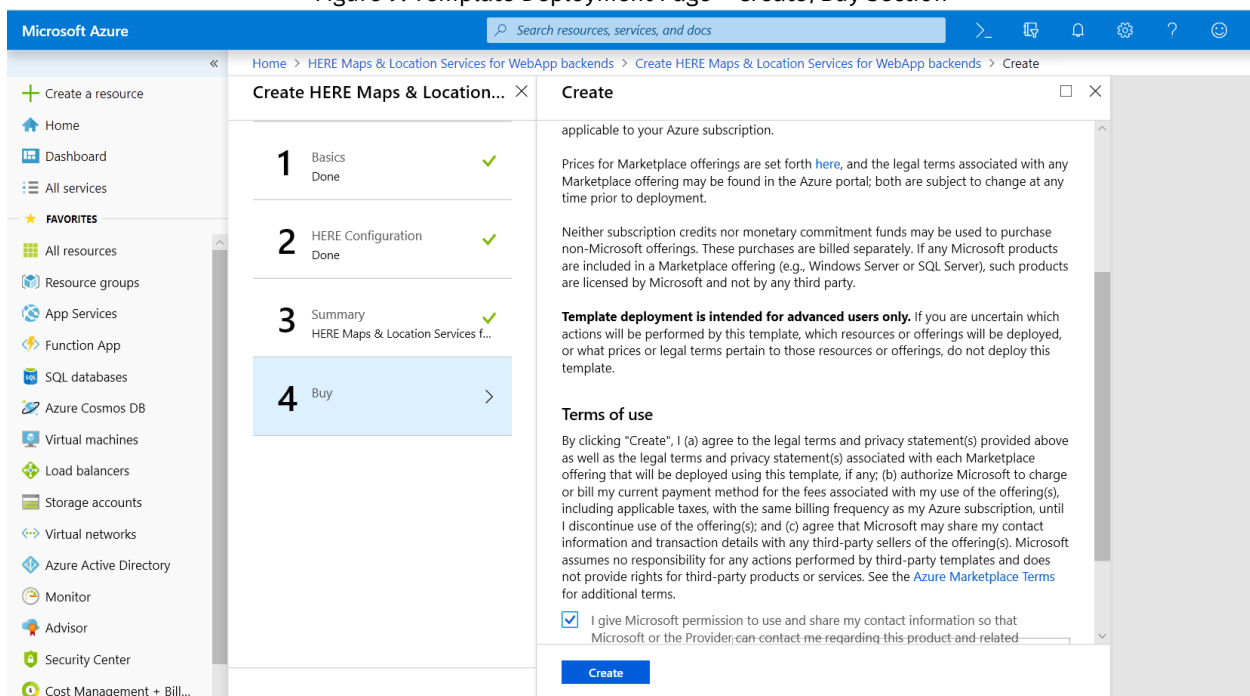

**Step 8:** Deployment should have started, and you will be able to see in the notification tabs deployment in progress. Once deployment is complete, you should receive the notification of the same and be able to see new resources in the resources section of your account.

Figure 10: HERE Maps & Location Services WebApp Backend Template Deployed

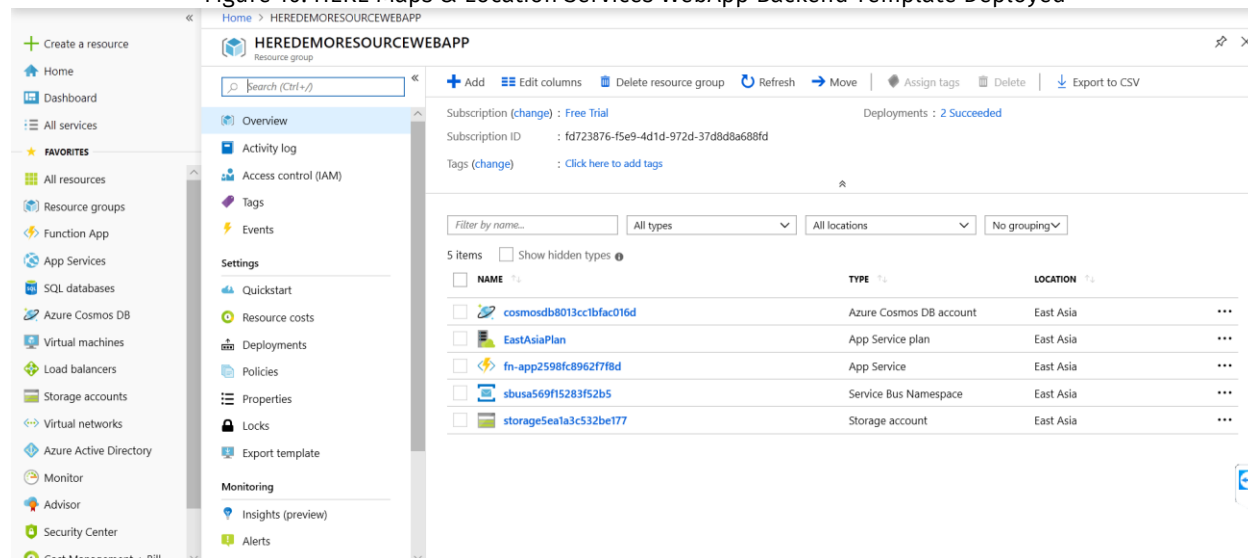

The screenshot shows the Azure portal interface for the resource group 'HEREDEMORESOURCEWEBAPP'. The left sidebar contains navigation options like 'Create a resource', 'Home', 'Dashboard', 'All services', and 'FAVORITES'. The main area displays the 'Overview' tab for the resource group, showing subscription details and a list of resources.

NAME	TYPE	LOCATION
cosmosdb8013cc1bfac016d	Azure Cosmos DB account	East Asia
EastAsiaPlan	App Service plan	East Asia
fn-app2598fc896277f8d	App Service	East Asia
sbusa569f15283f52b5	Service Bus Namespace	East Asia
storage5ea1a3c532be177	Storage account	East Asia